

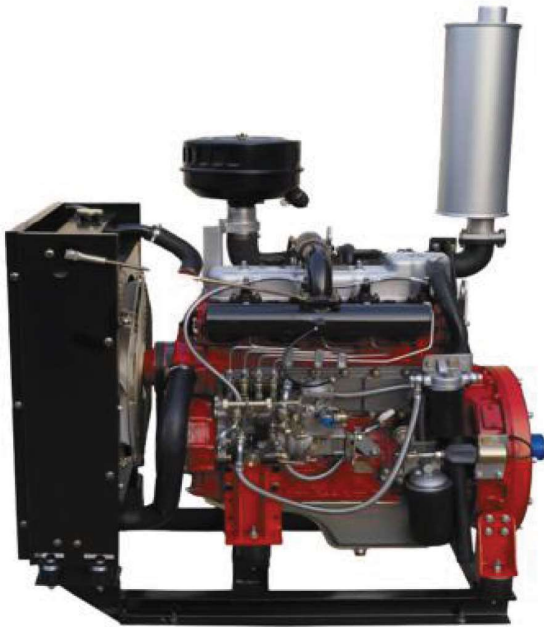

# MAC-TECH DIESEL ENGINE

## MD4105T



### Specification

<b>Engine Model</b>		<b>MD4105T</b>
<b>Type</b>		Vertical, water-cooling, 4-stroke, direct-injector
<b>Aspiration</b>		Turbo-charged
<b>Number of Cylinders</b>		4
<b>Bore X Stroke (mm)</b>		105X118
<b>Compression Ratio</b>		17.5:1
<b>Total Displacement (L)</b>		4.085
<b>Rated Power</b>	KW/HP	90/122
<b>Rated Speed</b>	r/min	3000
<b>Max. torque</b>	N.m	≥315
<b>Fuel Consumption</b>	g/kw.h	≤238
<b>Rotating Direction at Output End</b>		Counter-clockwise
<b>Lubrication Oil</b>		15W40
<b>Lubrication Oil Content</b>	L	11
<b>Lubrication Method</b>		Pressure and splash
<b>Starting Method</b>		Electric
<b>PTO Type</b>		Option: 1. Shaft 2. Coupling 3. Drive Plate
<b>Net Mass</b>	kg	500

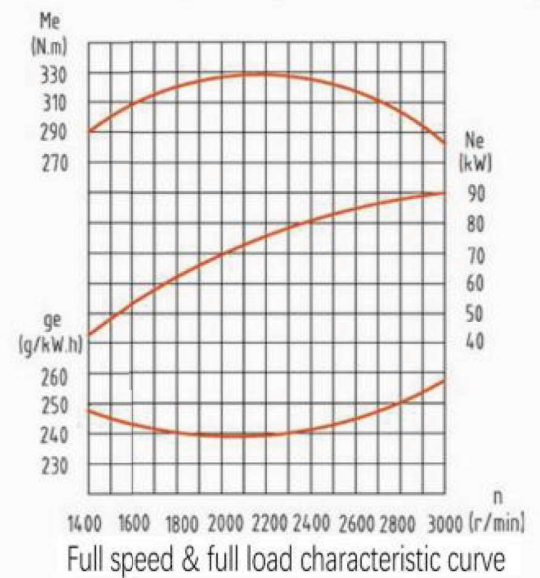
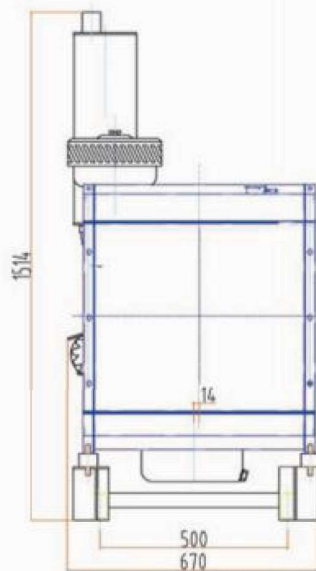
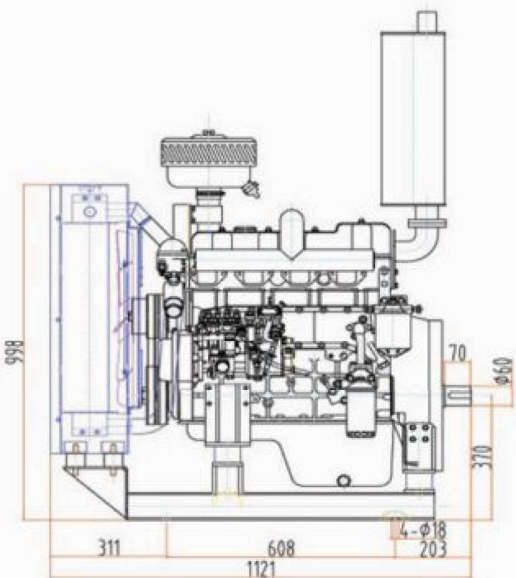

**MAC-TECH ENGINEERING SDN. BHD.** (156877-M)  
 21 & 23, Jalan 3/118C, Desa Tun Razak Industrial Park,  
 Cheras, 56000 Kuala Lumpur, West Malaysia.  
 Tel: (6) 03-91732606 (Hunting Line), 91732601, 91732602, 91732603  
 Fax: (6) 03-91732755, 91732893  
 Email: enquiry@mac-tech.com.my ■ http://www.mac-tech.com.my



**MAC-TECH DIESEL ENGINE**